

## Package Contents / 包裝內容物

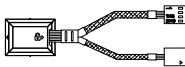

x 4 pcs



x 1 pc



x 1 pc

## Power Module Installation / 電源片安裝

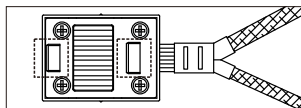

Note! The socket for the power module are in different size, please be aware of the direction.

注意! 電源片分為大小兩種卡榫, 安裝時須注意方向性。

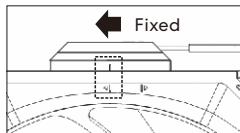
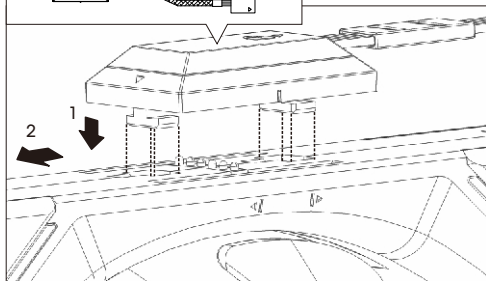
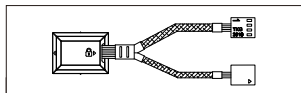

## Remove the Fan Interlocking Key / 風扇扣鎖拆除

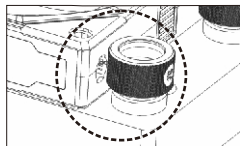
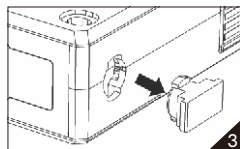
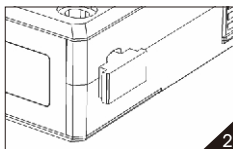
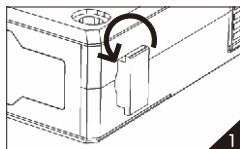

Note! The fan interlocking key is removable if it is affected by the radiator inlet and outlet.

注意! 若遇到水冷排水位置影響風扇扣鎖, 可將風扇卡扣鎖移除。

## Fan to Fan Connection / 風扇連接風扇

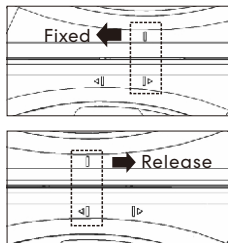
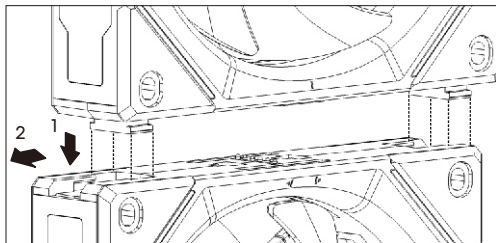

## Steps to Switch Orientation of the Cable on the Power Module /

### 電源片電線轉換方向示意

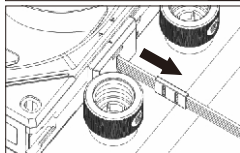
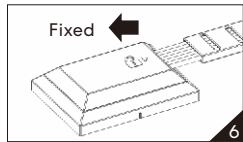
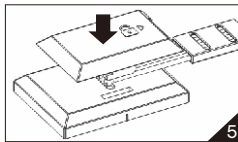
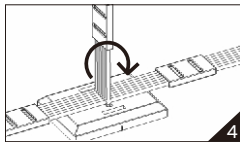
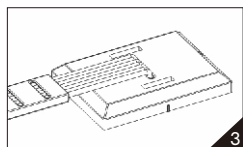
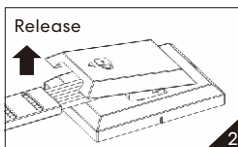
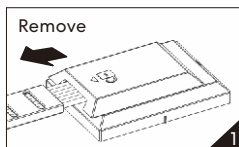

Note! The top cover is removable if it is affected by the radiator inlet and outlet, and route the cable vertically.

注意! 若遇到水冷排水位置影響電源片上蓋, 可將上蓋移除, 以垂直方式走線。

## Power Module to Motherboard connection / 電源片連接主板

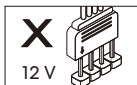
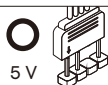
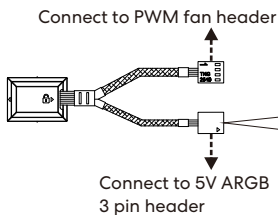

Warning! Do not connect the wrong type of LED connector. If it is connected to the 12 V connector, permanent damage will occur.

警告! 請不要連接錯誤類型的LED接頭, 如果連接到12V接口, 將造成永久損壞。