

6KVA. 10KVA ONLINE TOWER UPS



CHAMP TOWER SERIES



Pure sinewave



Generator
Compatible



Building
Emergency



Long
Autonomy

High Flexibility Online UPS Solutions

Champ Series is the high power density double-conversion online UPS with an output power factor of 0.9. It's designed in a small cabinet with a microprocessor controller.

Champ Series also has USB and RS-232 communication ports as standard, with a built-in intelligent slot for additional adapters, protocol converters, and related contact cards.

GENERAL FEATURES

- True double-conversion
- Microprocessor control optimizes reliability
- Input power factor correction ≥ 0.99
- Output power factor 0.9
- Wide input voltage (130 V - 280 V)
- Converter mode available
- Generator compatible
- Smart SNMP works well with either USB or RS-232 together display allows easy monitoring and access of UPS status
- Adjustable battery numbers 16, 17, 18, 19, 20 pcs.



FSP GROUP

FORTRON/SOURCE



TECHNICAL SPECIFICATIONS

MODEL	Champ T 6KL	Champ T 10KL
PHASE	Single phase with ground	
CAPACITY	6000 VA / 5400 W	10000 VA / 9000 W
INPUT		
Nominal Voltage	208/220/230/240 VAC	
Voltage Range	110-300 VAC (Based on load at 50%) 176-300 VAC (Based on load at 100%)	
Frequency Range	46~54 Hz or 56~64 Hz	
Power Factor	≥ 0.99 @ Nominal Voltage (100% Last)	
OUTPUT		
Nominal Voltage	208/220/230/240 VAC	
AC Voltage Regulation	± 1%	
Frequency Range(Synchronized Range)	46~54 Hz or 56~64 Hz	
Frequency Range(Batt. Mode)	50 Hz or 60Hz ± 0.1 Hz	
Current Crest Ratio	3:1	
Harmonic Distortion	≤ 3 % THD (Linear Load), ≤ 5 % THD (Non-linear Load)	
Transfer Time	Zero	
AC mode to Battery mode	Zero	
Inverter to Bypass	Zero	
Waveform (Batt. Mode)	Pure Sinewave	
EFFICIENCY		
Line Mode	92%	93%
Battery Mode	90%	91%
BATTERY		
Battery Type	9Ah / 10Ah	
Numbers	16 - 20pcs(Adjustable)	
Typical Recharge Time	NA	
Charging Current (max.)	1A, 2A, 4A, 6A (Adjustable,6A only for 16pcs batteries)	
Charging Voltage	218.4V±1%(based on 16pcs batteries)	
INDICATORS		
LCD Display	Last level, Battery level, AC mode, Battery mode, Bypass mode, and Fault indicators	
ALARM		
Battery Mode	Sounding every 4 seconds	
Low Battery	Sounding every second	
Overload	Sounding twice every second	
Fault	Continuously sounding	
AC INPUT & OUTPUT CONNECTORS		
AC Input Connector		
AC Output Connector	Terminal block	
STANDARDS		
Safety / EMC	IEC 62040-1 (safety) / IEC-62040-2 (EMC) / CE	
PHYSICAL		
Dimension, D x W x H(mm)	UPS Unit: 369 x 190 x 318 Battery Pack: 369 x 190 x 318	UPS Unit: 442 x 190 x 318 Battery Pack: 442 x 190 x 318
Net Weight (kgs)	UPS Unit: 12 Battery Pack:49	UPS Unit: 16 Battery Pack:49.5
ENVIRONMENT		
Operation Humidity	0-95% RH @ 0-50°C (non-condensing)	
Noise Level	Less than 50 dBA @ 1 Meter	
MANAGEMENT		
Smart RS-232 / USB	Supports Windows 2000/2003/XP/Vista/2008/7, Linux and MAC	
Optional SNMP	Power management from SNMP manager and web browser	

*1-3KVA: Derate to 80% of capacity in Frequency converter mode and to 80% when the output voltage is adjusted to 100/200/208VAC.
6-10KVA: Derate to 60% of capacity in Frequency converter mode and to 90% when the output voltage is adjusted to 208VAC.
Product specifications are subject to change without further notice.

		25%	50%	75%	100%
Champ T 6KL	+1 set BB-192/09T (16pcs 9Ah)	40	15	9	6
	+1 set BB-240/10T (20pcs 10Ah)	68	27	18	12
Champ T 10KL	+1 set BB-192/09T (16pcs 9Ah)	21	8	4	2
	+1 set BB-240/10T (20pcs 10Ah)	40	16	9	6

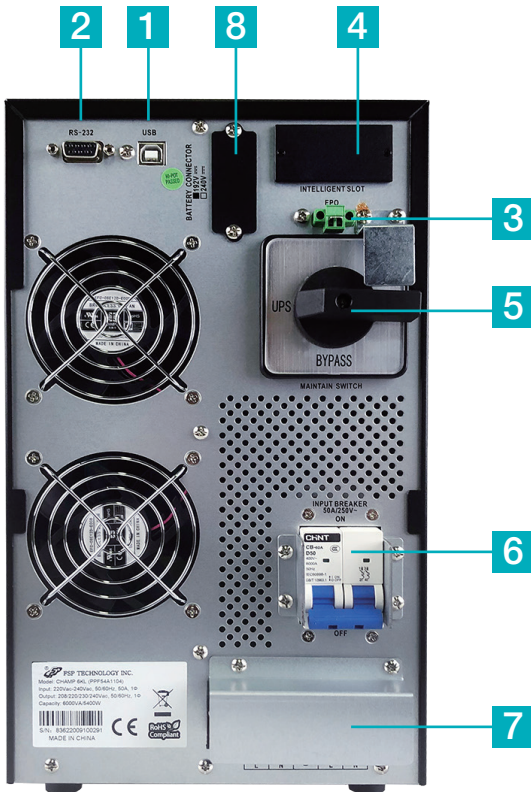

- 1 USB interface
- 2 RS-232 interface
- 3 Emergency stop (EPO)
- 4 Intelligent slot for SNMP / AS400 / RS485-Modbus
- 5 Manual Bypass.
- 6 Input protector.
- 7 Terminal cover.
- 8 External battery connector

Contents in package

- Battery cabel
- Viewpower CD
- USB cable
- User Manual

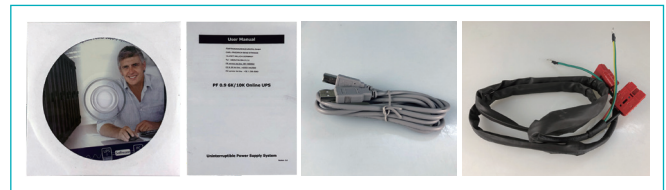

Saving recharging time

Saving recharging time by adjustable current 1,2,4,6A through UPS panel.

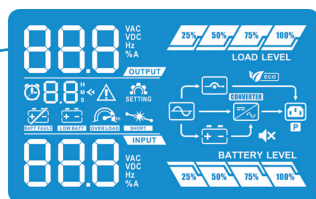

Easy Maintenance

Built-in maintenance bypass to shorten maintenance time and secure operation safety.

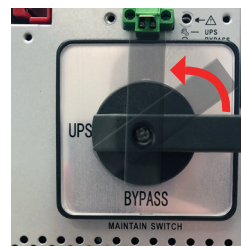

High Flexibility for Your Project Budget

Compatible with the battery up to 100Ah, maximum 6 external cabinets. Each cabinet is with adjustable 16-20pcs battery. It flexibly adapts your project budget and backup time.





16, 17, 18, 19, 20pcs

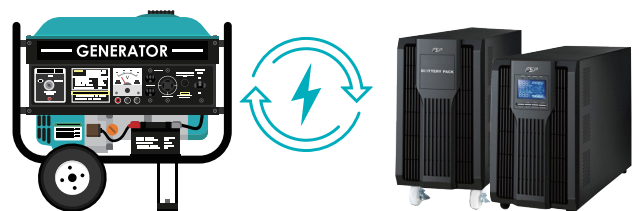

Generator compatible

Connecting with generator for building emergency situation.



Battery Cabinet				
Model	P/N	Pictures	Champ Tower	Battery
BB-192/09T	MPF0011900GP		Champ T 6KL Champ T 10KL	Battery bank with 16,17,18,19,20 pcs 9Ah battery Contact FSP local authorized partner for battery adjustment
BB-240/10T	MPF0011901GP		Champ T 6KL Champ T 10KL	Battery bank with 16,17,18,19,20 pcs 10Ah battery Contact FSP local authorized partner for battery adjustment

Network Management				
SNMP card SNMP box	MPF0000400GP 31-011163-07G		<ol style="list-style-type: none"> 1. Allows control and monitoring of UPS 2. Real-time dynamic graphs of UPS data 3. Warning notifications via audible alarm, broadcast, mobile messenger, e-mail 	
Modbus card	S98-000051-07091G		<ol style="list-style-type: none"> 1. Real-time control and monitoring of UPS 2. Supports Modbus RTU protocol 3. Provides MODBUS functions including read Holding Registers and write Registers 4. Provides surge protection 	
Relay card	MPF0007500GP		<ol style="list-style-type: none"> 1. The AS400 communication card provides contact closures for remote monitoring UPS. 2. To meet different application requirement, the AS400 card is capable of selection the status of the dry-contact signal (active close or active open) by setting jumper. 	
Environment Monitor Device	98-000069-00G		<ol style="list-style-type: none"> 1. Measure temperatures between 0 to 100°C with an accuracy of $\pm 1.5^{\circ}\text{C}$ 2. Measure relative humidity between 10 to 90% RH with an accuracy of $\pm 3\%$ Optional smoke alarm available 	
EPO cable	5370-1000-0011		<ol style="list-style-type: none"> 1. Cable to connect emergency power off port. 	
Battery cable	10-112480-00G		<ol style="list-style-type: none"> 1. Cable to connect UPS and external battery cabinet. 	