

BENEFITS:

- More cost-benefits for everyday use
- Good performance on moderate to low-drain devices

APPLICATIONS BEST FOR:



Other Details:

- Carbon Zinc chemistry
- Cylindrical cell type
- Average weight: 47.8g

Typical Service Life:

Discharge Resistance	Discharge Condition	End Point Voltage	Service Life
3.9 ohms	1 Hr/Day	0.8V	7.2 Hrs

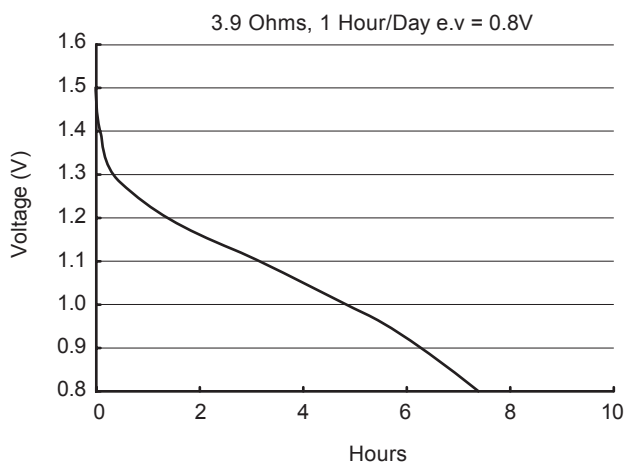

- GP Supercell Carbon Zinc Battery
- C size
- 1.5 Volts

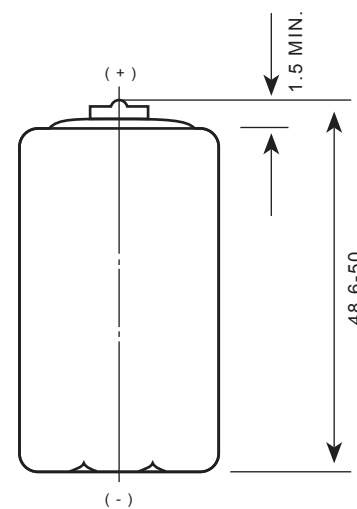
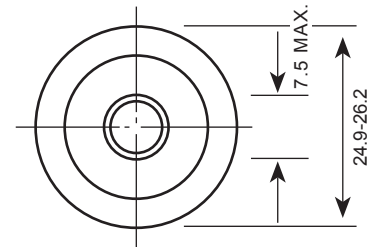

Unit : mm